

# OCEAN CITY'S "IMPERIAL" REEL NO. 910 (Model A)

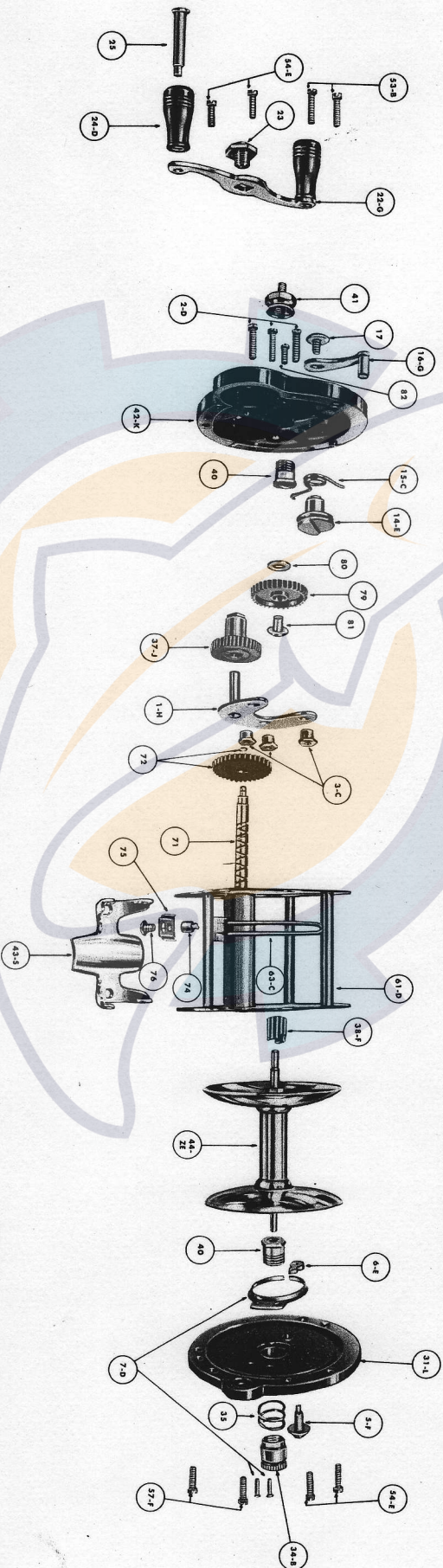

**HOW TO ORDER PARTS FOR YOUR REEL**—Locate the part desired in the illustration above and note part number. When ordering, state quantity, part name and model letter which you will find on underside of reel stand. Enclose money order, stamps or check. Our minimum charge for one order is \$25; please add \$15 on each order for return postage and insurance.

PART No.	PART NAME	PRICE	PART No.	PART NAME	PRICE	PART No.	PART NAME	PRICE	PART No.	PART NAME	PRICE
1-H	Bridge	.30	61-D	Frame Only (Does not include Part Nos. 71 and 63-C)	1.50	31-L	Left Side Plate (Includes Part Nos. 5-F, 6-E, and 7-D)	.50	43-S	Stand	.60
2-D	Bridge Screw	.02	22-G	Handle Complete with Knobs	.80	34-B	Left Side Oil Cap	.12	53-B	Screw, Right Side Plate	.02
3-C	Bridge Screw Nut	.04	24-D	Handle Knob	.14	35	Left Side Oil Cap Spring	.04	54-E	Screw, Right Stand and Left Plate	.02
5-F	Click Button	.12	25	Handle Knob Rivet	.06	40	Left and Right Side Bearing	.20	57-F	Screw, Left Side Stand	.02
6-E	Click Pawl	.08	23	Handle Screw	.26	37-J	Main Gear	.45	71	Worm	.40
7-D	Click Spring and Rivets	.14	79	Intermediate Gear	.20	38-F	Pinion Gear	.30	72	Worm Gear and Lock Ring	.24
14-E	Eccentric	.50	80	Intermediate Gear Washer	.01	42-K	Right Side Plate	.50	74	Worm Pawl	.10
15-C	Eccentric Spring	.12	81	Intermediate Gear Stud	.04	41	Right Side Adjusting Cap	.12	75	Worm Pawl Cover	.02
16-G	Free Spool Lever	.24	82	Intermediate Gear Stud Screw	.02	44-ZE	Spool	1.00	76	Worm Pawl Cover Screw	.02
17	Free Spool Lever Screw	.05							63-C	Line Guide	.36